

PE BALL VALVE

Water - 240 PSI at 73 Deg F Sustainable
Maximum Operating Pressure

Gas - 150 PSI at 73 Deg F Sustainable
Maximum Operating Pressure

Engineered for PE3408, PE4710 & PE100 HDPE Pipe
Systems Manufactured in accordance with ASTM F-714,
ASTM F-1055, ASTM D-2513, ASTM D-3035, ASTM
D-3261, ASTM D-3350, AWWA C-901, AWWA C-906,
DIN16963, EN1555, EN12201

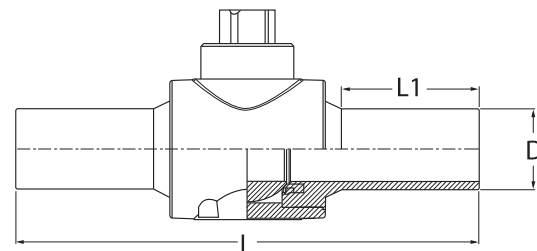

Nominal Pipe Size (D)	Base Norm	CODE	L (inc)	L1 (mm)
1/2"	IPS	30.KV0.11.11.0021	11.02	2.76
3/4"	CTS	30.KV1.33.11.0022	11.02	2.76
3/4"	IPS	30.KV1.11.11.0026	9.84	2.36
1"	IPS	30.KV1.11.11.0033	10.63	2.56
1 1/4"	IPS	30.KV1.11.11.0042	14.17	3.94
1 1/2"	IPS	30.KV1.11.11.0048	14.17	3.94
2"	IPS	30.KV1.11.11.0060	14.56	4.33
3"	IPS	30.KV1.11.11.0088	20.00	4.53
4"	IPS	30.KV1.11.11.0114	20.47	4.92
6"	IPS	30.KV1.11.11.0168	24.4	6.30