

## SDR11 ELECTROFUSION VALVE TAPPING TEES

**Water** - 240 PSI at 73 Deg F Sustainable Maximum Operating Pressure

- Suitable for Water, Fluids & Slurry's
- Engineered for PE3408, PE4710 & PE100 HDPE Pipe Systems
  - Manufactured in accordance with ASTM F-714, ASTM F-1055, ASTM D-2513, ASTM D-3035, ASTM D-3261, ASTM D-3350, AWWA C-901, AWWA C-906, DIN16963, EN1555, EN12201 ISO-9001 Certified

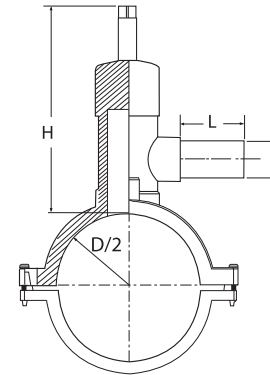

TYPE A



TYPE B



TYPE C



TYPE D

BASE (D)	BASE NORM	OUTLET (d)	OUTLET NORM	H	L	Unit Weight in lbs	TYPE	Item Code
2"	IPS	1/2"	CTS	6,30	1,97	1,83	A	30.VS1.13.11.6015
2"	IPS	1/2"	IPS	6,30	1,97	1,87	A	30.VS1.11.11.6021
2"	IPS	3/4"	CTS	6,30	1,97	1,87	A	30.VS1.13.11.6022
2"	IPS	3/4"	IPS	6,30	1,97	1,90	A	30.VS1.11.11.6026
2"	IPS	1"	CTS	6,30	1,97	1,90	A	30.VS1.13.11.6028
2"	IPS	1"	IPS	6,30	2,95	1,92	A	30.VS1.11.11.6033
2"	IPS	1 1/4"	IPS	6,30	2,95	1,94	B	30.VS1.11.11.6042
2"	IPS	1 1/4"	CTS	6,30	2,95	1,92	A	30.VS1.13.11.6034
2"	IPS	1 1/2"	IPS	10,63	3,66	4,63	B	30.VS1.11.11.6048
2"	IPS	2"	IPS	10,63	3,66	4,74	B	30.VS1.11.11.6060
3"	IPS	1/2"	CTS	8,46	1,57	3,75	A	30.VS1.13.11.8815
3"	IPS	1/2"	IPS	8,46	1,57	3,79	A	30.VS1.11.11.8821
3"	IPS	3/4"	CTS	8,46	1,57	3,79	A	30.VS1.13.11.8822
3"	IPS	3/4"	IPS	8,46	1,97	3,81	A	30.VS1.11.11.8826
3"	IPS	1"	CTS	8,46	1,97	3,81	A	30.VS1.13.11.8828
3"	IPS	1"	IPS	8,46	2,95	3,84	A	30.VS1.11.11.8833
3"	IPS	1 1/4"	IPS	8,46	3,23	3,86	A	30.VS1.11.11.8842
3"	IPS	1 1/4"	CTS	8,46	2,95	3,84	A	30.VS1.13.11.8834
3"	IPS	1 1/2"	IPS	9,84	3,35	5,91	C	30.VS1.11.11.8848
3"	IPS	2"	IPS	9,84	3,35	5,93	C	30.VS1.11.11.8860



### SDR11 ELECTROFUSION VALVE TAPPING TEES

Water - 240 PSI at 73 Deg F Sustainable Maximum Operating Pressure

- Suitable for Water, Fluids & Slurry's
- Engineered for PE3408, PE4710 & PE100 HDPE Pipe Systems
- Manufactured in accordance with ASTM F-714, ASTM F-1055, ASTM D-2513, ASTM D-3035, ASTM D-3261, ASTM D-3350, AWWA C-901, AWWA C-906, DIN16963, EN1555, EN12201 ISO-9001 Certified

BASE (D)	BASE NORM	OUTLET (d)	OUTLET NORM	H	L	Unit Weight in lbs	TYPE	Item Code
4"	IPS	1/2"	CTS	8,46	1,57	3,84	A	30.VS1.13.11.1115
4"	IPS	1/2"	IPS	8,46	1,57	3,90	A	30.VS1.11.11.11121
4"	IPS	3/4"	CTS	8,46	1,57	3,90	A	30.VS1.13.11.11122
4"	IPS	3/4"	IPS	8,46	2,24	3,92	A	30.VS1.11.11.11126
4"	IPS	1"	CTS	8,46	2,24	3,92	A	30.VS1.13.11.11128
4"	IPS	1"	IPS	8,46	2,80	3,95	A	30.VS1.11.11.11133
4"	IPS	1 1/4"	IPS	8,46	2,83	3,99	A	30.VS1.11.11.11142
4"	IPS	1 1/4"	CTS	8,46	2,80	3,95	A	30.VS1.13.11.11134
4"	IPS	1 1/2"	IPS	9,84	2,95	5,95	C	30.VS1.11.11.11148
4"	IPS	2"	IPS	9,84	2,95	6,02	C	30.VS1.11.11.11160
6"	IPS	1/2"	CTS	8,46	1,57	4,32	C	30.VS1.13.11.111615
6"	IPS	1/2"	IPS	8,46	1,57	4,39	C	30.VS1.11.11.111621
6"	IPS	3/4"	CTS	8,46	1,57	4,39	C	30.VS1.13.11.111622
6"	IPS	3/4"	IPS	8,46	1,97	4,41	C	30.VS1.11.11.111626
6"	IPS	1"	CTS	8,46	1,97	4,41	C	30.VS1.13.11.111628
6"	IPS	1"	IPS	8,46	2,64	4,43	C	30.VS1.11.11.111633
6"	IPS	1 1/4"	IPS	8,46	2,64	4,45	C	30.VS1.11.11.111642
6"	IPS	1 1/4"	CTS	8,46	2,64	4,43	C	30.VS1.13.11.111634
6"	IPS	1 1/2"	IPS	9,84	2,95	6,44	C	30.VS1.11.11.111648
6"	IPS	2"	IPS	9,84	2,95	6,48	C	30.VS1.11.11.111660
7"	IPS	1/2"	CTS	8,46	1,57	4,32	C	30.VS1.13.11.111815
7"	IPS	1/2"	IPS	8,46	1,57	4,39	C	30.VS1.11.11.111821
7"	IPS	3/4"	CTS	8,46	1,57	4,39	C	30.VS1.13.11.111822
7"	IPS	3/4"	IPS	8,46	1,97	4,41	C	30.VS1.11.11.111826
7"	IPS	1"	CTS	8,46	1,97	4,41	C	30.VS1.13.11.111828
7"	IPS	1"	IPS	8,46	2,91	4,43	C	30.VS1.11.11.111833
7"	IPS	1 1/4"	IPS	8,46	2,91	4,45	C	30.VS1.11.11.111842
7"	IPS	1 1/4"	CTS	8,46	2,91	4,43	C	30.VS1.13.11.111834
7"	IPS	1 1/2"	IPS	9,84	2,91	6,44	C	30.VS1.11.11.111848
7"	IPS	2"	IPS	9,84	2,91	6,48	C	30.VS1.11.11.111860
8"	IPS	1/2"	CTS	8,46	1,57	4,19	C	30.VS1.13.11.112115
8"	IPS	1/2"	IPS	8,46	1,57	4,26	C	30.VS1.11.11.112121
8"	IPS	3/4"	CTS	8,46	1,57	4,26	C	30.VS1.13.11.112122
8"	IPS	3/4"	IPS	8,46	1,97	4,26	C	30.VS1.11.11.112126
8"	IPS	1"	CTS	8,46	1,97	4,26	C	30.VS1.13.11.112128
8"	IPS	1"	IPS	8,46	2,95	4,28	C	30.VS1.11.11.112133
8"	IPS	1 1/4"	IPS	8,46	2,95	4,30	C	30.VS1.11.11.112142
8"	IPS	1 1/4"	CTS	8,46	2,95	4,28	C	30.VS1.13.11.112134
8"	IPS	1 1/2"	IPS	9,84	2,95	6,28	C	30.VS1.11.11.112148
8"	IPS	2"	IPS	9,84	2,95	6,33	C	30.VS1.11.11.112160
10"	IPS	1/2"	CTS	10,04	1,57	5,40	D	30.VS1.13.11.112715
10"	IPS	1/2"	IPS	10,04	1,57	5,47	D	30.VS1.11.11.112721
10"	IPS	3/4"	CTS	10,04	1,57	5,49	D	30.VS1.13.11.112722
10"	IPS	3/4"	IPS	10,04	1,97	5,49	D	30.VS1.11.11.112726
10"	IPS	1"	CTS	10,04	1,97	5,49	D	30.VS1.13.11.112728
10"	IPS	1"	IPS	10,04	2,95	5,51	D	30.VS1.11.11.112733
10"	IPS	1 1/4"	IPS	10,04	2,95	5,53	D	30.VS1.11.11.112742
10"	IPS	1 1/4"	CTS	10,04	2,95	5,51	D	30.VS1.13.11.112734
10"	IPS	1 1/2"	IPS	10,04	2,95	5,60	D	30.VS1.11.11.112748
10"	IPS	2"	IPS	10,04	2,95	5,62	D	30.VS1.11.11.112760
3"	DIPS	1/2"	CTS	8,46	1,57	3,86	A	30.VS1.23.11.11015

EF METRIK  
EF METRIC

EF INCH

SPIGOT  
SPIGOT

VANA  
VALVE

MAKINE VE APARAT  
MACHINES & TOOL

MONTAJ  
INSTALLATION

TEKNIK  
TECHNICAL



### SDR11 ELECTROFUSION VALVE TAPPING TEES

Water - 240 PSI at 73 Deg F Sustainable Maximum Operating Pressure

- Suitable for Water, Fluids & Slurry's
- Engineered for PE3408, PE4710 & PE100 HDPE Pipe Systems
- Manufactured in accordance with ASTM F-714, ASTM F-1055, ASTM D-2513, ASTM D-3035, ASTM D-3261, ASTM D-3350, AWWA C-901, AWWA C-906, DIN16963, EN1555, EN12201 ISO-9001 Certified

BASE (D)	BASE NORM	OUTLET (d)	OUTLET NORM	H	L	Unit Weight in lbs	TYPE	Item Code
3"	DIPS	1/2"	IPS	8,46	1,57	3,90	A	30.VS1.21.11.1021
3"	DIPS	3/4"	CTS	8,46	1,57	3,90	A	30.VS1.23.11.1022
3"	DIPS	3/4"	IPS	8,46	2,24	3,92	A	30.VS1.21.11.1026
3"	DIPS	1"	CTS	8,46	2,24	3,92	A	30.VS1.23.11.1028
3"	DIPS	1"	IPS	8,46	2,80	3,95	A	30.VS1.21.11.1033
3"	DIPS	1 1/4"	IPS	8,46	2,83	3,99	A	30.VS1.21.11.1042
3"	DIPS	1 1/4"	CTS	8,46	2,80	3,95	A	30.VS1.23.11.1034
3"	DIPS	1 1/2"	IPS	9,84	2,95	5,95	C	30.VS1.21.11.1048
3"	DIPS	2"	IPS	9,84	2,95	6,02	C	30.VS1.21.11.1060
4"	DIPS	1/2"	CTS	8,46	2,80	3,86	A	30.VS1.23.11.1215
4"	DIPS	1/2"	IPS	8,46	2,80	3,90	A	30.VS1.21.11.1221
4"	DIPS	3/4"	CTS	8,46	2,80	3,90	A	30.VS1.23.11.1222
4"	DIPS	3/4"	IPS	8,46	2,83	3,92	A	30.VS1.21.11.1226
4"	DIPS	1"	CTS	8,46	2,83	3,92	A	30.VS1.23.11.1228
4"	DIPS	1"	IPS	8,46	2,80	3,95	A	30.VS1.21.11.1233
4"	DIPS	1 1/4"	IPS	8,46	2,83	3,99	A	30.VS1.21.11.1242
4"	DIPS	1 1/4"	CTS	8,46	2,80	3,95	A	30.VS1.23.11.1234
4"	DIPS	1 1/2"	IPS	9,84	3,03	5,95	C	30.VS1.21.11.1248
4"	DIPS	2"	IPS	9,84	2,56	6,02	C	30.VS1.21.11.1260
6"	DIPS	1/2"	CTS	8,46	1,57	4,34	C	30.VS1.23.11.1715
6"	DIPS	1/2"	IPS	8,46	1,57	4,39	C	30.VS1.21.11.1721
6"	DIPS	3/4"	CTS	8,46	1,57	4,39	C	30.VS1.23.11.1722
6"	DIPS	3/4"	IPS	8,46	1,97	4,41	C	30.VS1.21.11.1726
6"	DIPS	1"	CTS	8,46	1,97	4,41	C	30.VS1.23.11.1728
6"	DIPS	1"	IPS	8,46	2,91	4,43	C	30.VS1.21.11.1733
6"	DIPS	1 1/4"	IPS	8,46	2,91	4,45	C	30.VS1.21.11.1742
6"	DIPS	1 1/4"	CTS	8,46	2,91	4,43	C	30.VS1.23.11.1734
6"	DIPS	1 1/2"	IPS	9,84	2,91	6,44	C	30.VS1.21.11.1748
6"	DIPS	2"	IPS	9,84	2,91	6,48	C	30.VS1.21.11.1760
8"	DIPS	1/2"	CTS	10,04	1,57	4,21	C	30.VS1.21.11.2215
8"	DIPS	1/2"	IPS	10,04	1,57	4,26	C	30.VS1.21.11.2221
8"	DIPS	3/4"	CTS	10,04	1,57	4,26	C	30.VS1.23.11.2222
8"	DIPS	3/4"	IPS	10,04	1,97	4,26	C	30.VS1.21.11.2226
8"	DIPS	1"	CTS	10,04	1,97	4,26	C	30.VS1.23.11.2228
8"	DIPS	1"	IPS	10,04	2,95	4,28	C	30.VS1.21.11.2233
8"	DIPS	1 1/4"	IPS	10,04	2,95	4,30	C	30.VS1.21.11.2242
8"	DIPS	1 1/4"	CTS	10,04	2,95	4,28	C	30.VS1.23.11.2234
8"	DIPS	1 1/2"	IPS	10,04	2,95	6,28	C	30.VS1.21.11.2248
8"	DIPS	2"	IPS	10,04	2,95	6,33	C	30.VS1.21.11.2260
10"	DIPS	1/2"	CTS	10,04	1,57	5,40	D	30.VS1.23.11.2815
10"	DIPS	1/2"	IPS	10,04	1,57	5,47	D	30.VS1.21.11.2821
10"	DIPS	3/4"	CTS	10,04	1,57	5,47	D	30.VS1.23.11.2822
10"	DIPS	3/4"	IPS	10,04	1,97	5,49	D	30.VS1.21.11.2826
10"	DIPS	1"	CTS	10,04	1,97	5,49	D	30.VS1.23.11.2828
10"	DIPS	1"	IPS	10,04	2,95	5,51	D	30.VS1.21.11.2833
10"	DIPS	1 1/4"	IPS	10,04	2,95	5,53	D	30.VS1.21.11.2842
10"	DIPS	1 1/4"	CTS	10,04	2,95	5,51	D	30.VS1.23.11.2834
10"	DIPS	1 1/2"	IPS	10,04	2,95	5,60	D	30.VS1.21.11.2848
10"	DIPS	2"	IPS	10,04	2,95	5,62	D	30.VS1.21.11.2860

EF METRIK

EF INCH

SPIGOT

VANA VALVE

MAKINE VE APARAT MACHINES & TOOL

MONTAJ INSTALLATION

TEKNIK TECHNICAL